



SAFETY ZONE DIMENSIONS
 Permanent speed limit 30mph or less
 Sideways safety zone 0.5m
 Longways safety zone 0.5m
 (Dimensions are minima)

Sign Code	Sign Description	Sign Image
A1	Priority	
A2	Priority	
A3	Priority	
A4	Priority	
A5	Priority	
A6	Priority	
A7	Priority	
A8	Priority	
A9	Priority	
A10	Priority	
A11	Priority	
A12	Priority	
A13	Priority	
A14	Priority	
A15	Priority	
A16	Priority	
A17	Priority	
A18	Priority	
A19	Priority	
A20	Priority	
A21	Priority	
A22	Priority	
A23	Priority	
A24	Priority	
A25	Priority	
A26	Priority	
A27	Priority	
A28	Priority	
A29	Priority	
A30	Priority	
A31	Priority	
A32	Priority	
A33	Priority	
A34	Priority	
A35	Priority	
A36	Priority	
A37	Priority	
A38	Priority	
A39	Priority	
A40	Priority	
A41	Priority	
A42	Priority	
A43	Priority	
A44	Priority	
A45	Priority	
A46	Priority	
A47	Priority	
A48	Priority	
A49	Priority	
A50	Priority	

DETAIL B

SingleDual carriageway 40mph or less - 450mm traffic cones, spacing 1.5m.
 SingleDual carriageway 50mph or more - 750mm traffic cones, spacing 1.5m.
 Dual carriageway national speed limit - 750mm traffic cones, spacing 1.5m.
 Release: 2m

Notes
 1) During delivery warning lights to BS EN 12352 2005 should be used.
 2) 45mm diameter traffic cones to BS EN 12352 2005 should be used.
 3) On motorways and M/A roads with hard shoulders 1m for headlamps and the facing wall of lane changes.

DETAIL D

SingleDual carriageway 40mph or less - 450mm traffic cones.
 SingleDual carriageway 50mph or more - 750mm traffic cones.
 SingleDual carriageway 50mph or more - 750mm traffic cones.
 1) During delivery warning lights to BS EN 12352 2005 should be provided as recommended in Table A.3 (Appendix 1).
 2) Detail D signed only in residential areas.

Time-way working	Standard National traffic marking	Restrictions: Cane and light vehicles
1:00 to 3:00 pm	1.2.2	1.2.2
3:00 to 6:00 pm	1.2.2	1.2.2
6:00 to 9:00 pm	1.2.2	1.2.2
9:00 to 12:00 am	1.2.2	1.2.2
12:00 to 1:00 am	1.2.2	1.2.2
1:00 to 3:00 am	1.2.2	1.2.2
3:00 to 6:00 am	1.2.2	1.2.2
6:00 to 9:00 am	1.2.2	1.2.2
9:00 to 12:00 pm	1.2.2	1.2.2
12:00 to 1:00 pm	1.2.2	1.2.2
1:00 to 3:00 pm	1.2.2	1.2.2

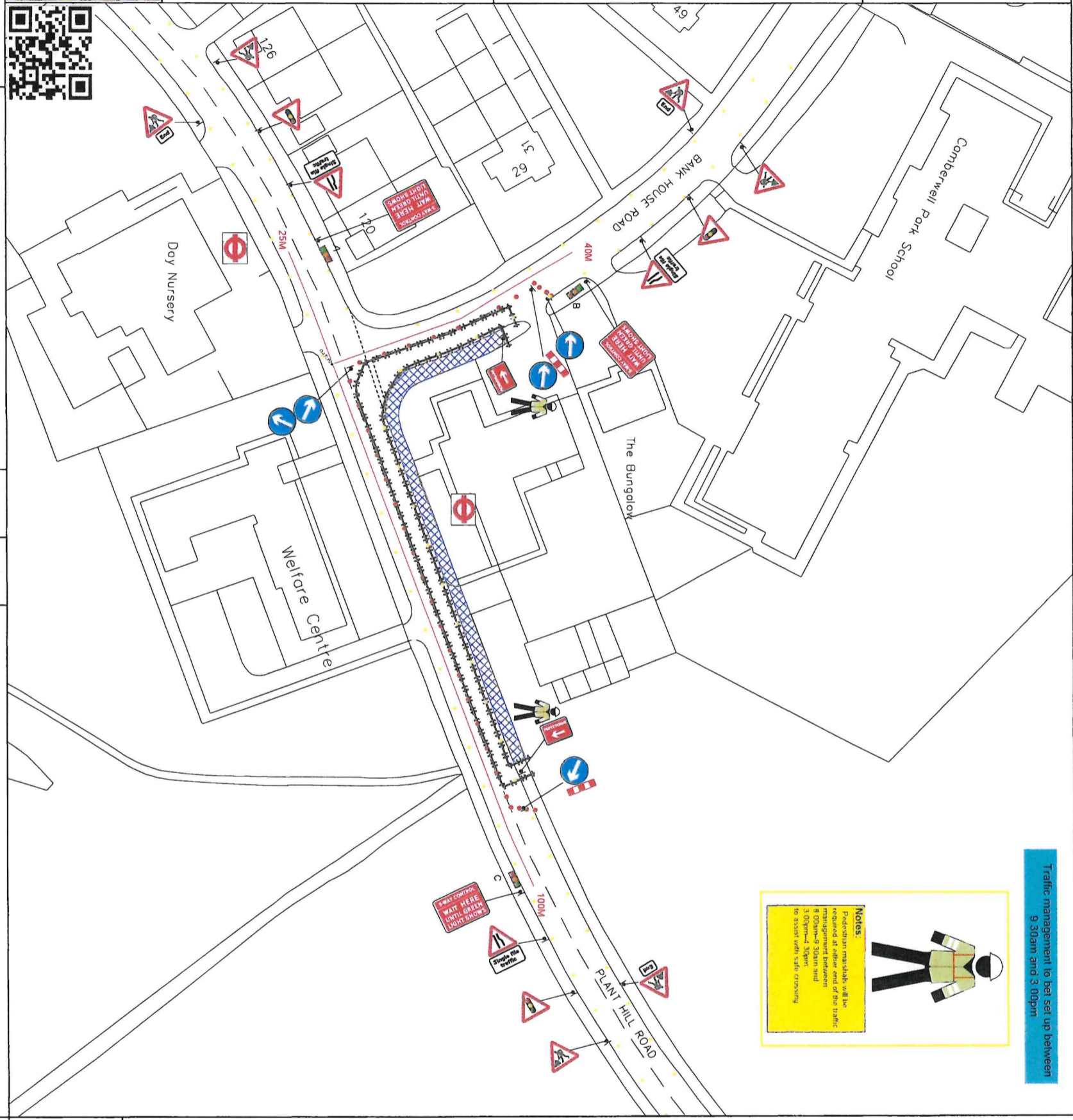

Traffic management to be set up between 9.30am and 3.00pm

Notes:
 Pedestrian marshals will be required at either end of the traffic management zone.
 400mm diameter - 30mm high - 300mm x 30mm - to avoid with safe crossing

TEMPORARY TRAFFIC MANAGEMENT PLAN

Issue	3
Date	20.04.2026
Drawn by	CT011

GreenSigns logo

3 WAY TRAFFIC LIGHTS + PED MANAGEMENT PLANT HILL ROAD / BANK HOUSE ROAD MANCHESTER, M9 8LX

KEY BARRIERS TO BE USED AT CROSSINGS

BUS STOP TO BE SUSPENDED AND RELOCATED FOR THE DURATION OF THE WORKS

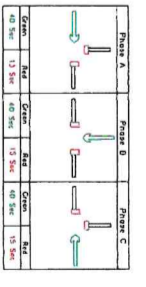

TSM Chapter 6 Pedestrian Timings
 (The following table is for reference only)

Speed-Designation	Speed (mph)	Distance (m)	Time (s)
10	10	10	1.0
20	20	20	1.0
30	30	30	1.0
40	40	40	1.0
50	50	50	1.0
60	60	60	1.0
70	70	70	1.0
80	80	80	1.0
90	90	90	1.0
100	100	100	1.0
110	110	110	1.0
120	120	120	1.0
130	130	130	1.0
140	140	140	1.0
150	150	150	1.0
160	160	160	1.0
170	170	170	1.0
180	180	180	1.0
190	190	190	1.0
200	200	200	1.0

Vehicle to Vehicle Allred Clearance Times

Vehicle	Clearance Time (s)
1.0	1.0
2.0	2.0
3.0	3.0
4.0	4.0
5.0	5.0
6.0	6.0
7.0	7.0
8.0	8.0
9.0	9.0
10.0	10.0
11.0	11.0
12.0	12.0
13.0	13.0
14.0	14.0
15.0	15.0
16.0	16.0
17.0	17.0
18.0	18.0
19.0	19.0
20.0	20.0

KEY

- Traffic sign
- Traffic cone
- Working Space
- Pedestrian Barrier

Drawing No - PTM1346
 PRIMUS TM
 Original drawing size A3 - NTS